

BARKER

4 bedroom terrace

A four bedroom three storey home with open-plan living accommodation, additional snug and glorious views across Bath.



PLOT: 25, 26, 27

House area: 170.7m² / 1837ft²

Kitchen/Dining: 7.76 x 3.69m / 25'5" x 12'1"

Snug: 3.05 x 3.75m / 10' x 12'4"

WC: 1 x 1.72m / 3'3" x 5'8"

Utility: 2.28 x 1.7m / 7'6" x 5'7"

Master Bedroom: 4.91 x 3m / 16'1" x 9'10"

En-suite: 2.55 x 2.25m / 8'4" x 7'5"

Bedroom 2: 3.05 x 3.75m / 12'7" x 13'1"

En-suite: 2.49 x 1.72m / 8'2" x 5'8"

Study: 2.23 x 2.15m / 7'4" x 7'1"

Living Room: 4.99 x 3.98m / 16'4" x 13'1"

Bedroom 3: 2.53 x 2.96m / 8'4" x 9'8"

Bedroom 4: 2.8 x 4m / 9'2" x 13'1"

Bathroom: 2.83 x 1.68m / 9'3" x 5'6"

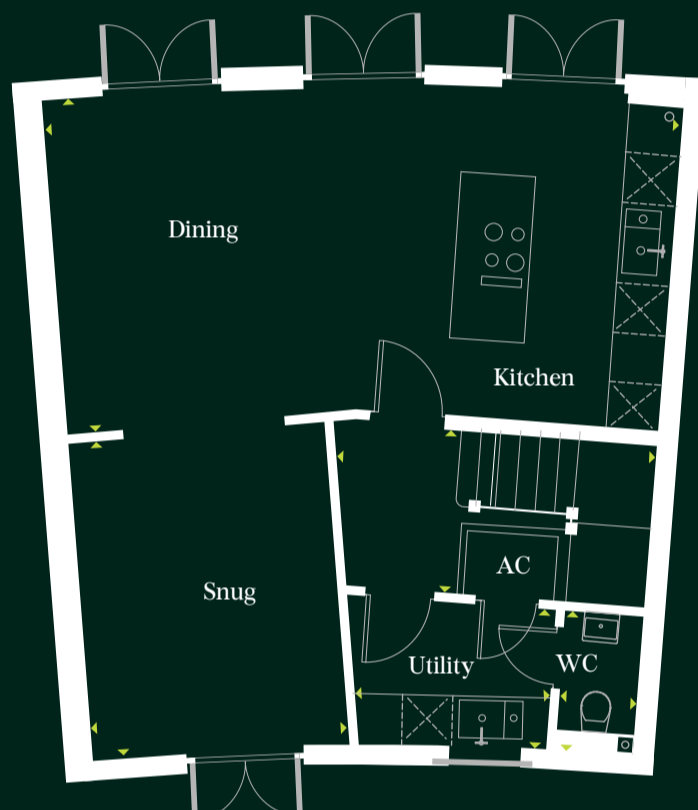

Lower Ground Floor

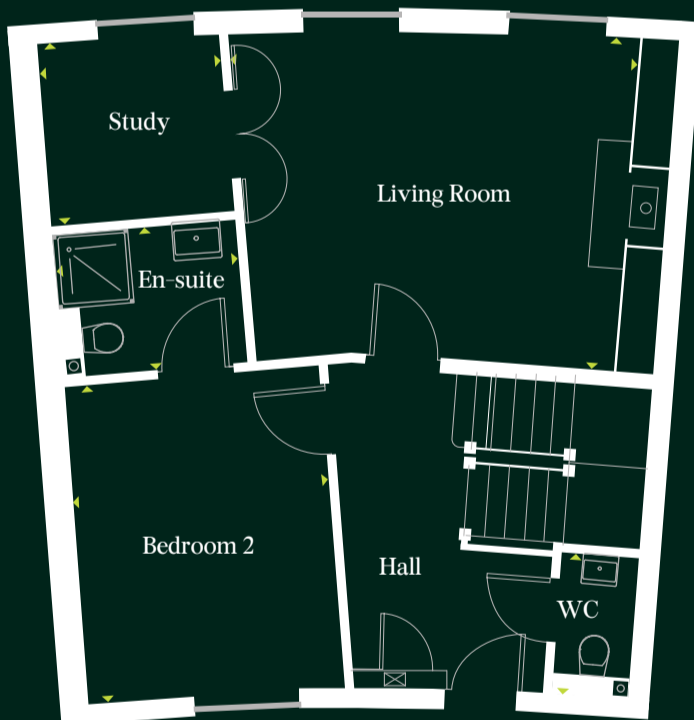

Ground Floor



First Floor

For more information, contact the Marketing Pavilion:
sales@holburnepark.co.uk | Tel: 01225 302 888 | www.holburnepark.co.uk

